

# thesocial

## FOH System and Specs

- \*24 channel Main Snake
- \*Soundcraft GB8
- \*Ashley GQX3102-House EQ
- \*DBX 480-System Processor for EAW cabinets
- \*Powersoft K3 on all EAW cabinets
- \*EAW KF737-top box in array/side
- \*2-EAW KF730/side
- \*EAW SB528z/side
- \*2-custom JBL 2-18"  
powered by QSC PLX3102 on AUX send

## FX

- \*Lexicon MPX1
- \*Lexicon MX300
- \*TC Electronic D2 w/tap pedal

## DYNAMICS

- \*DBX 1074-Gate
- \*2-DBX 166XL-Comp/Gate
- \*BSS DPR 404-Comp
- \*DBX 1076-Comp

## MONITORS:

- \*24 Channel Split w/patchbay
- \*16 Channel Allen&Heath MixWizard (6 mixes max)
- \*3-DBX 231-Graphic EQ
- \*4-custom JBL loaded, Bi-Amp Monitor Mixes, powered by Crown MacroTech 2406 w/ PIP card
- \*2-Passive Yamaha Monitor Mixes, powered by QSC PLX3102
- \*2-Gate
- \*4-Comp

## MICROPHONES & DI's:

- \*8-Shure SM58
- \*4-Shure SM57
- \*4-Shure Beta56
- \*2-Shure Beta58
- \*2-Shure Beta52
- \*3-Sennheiser e835
- \*2-Sennheiser e609
- \*Audix I5
- \*5-Passive Direct Boxes
- \*2-Stereo Passive Direct Boxes
- \*Countryman Active Direct Box
- \*7-Tall Boom Mic stands w/ tripod base
- \*9-Short Boom Mic stands
- \*2-Straight Mic stands w/ round base
- \*Adequate Microphone Cabling 15'-50'

## LIGHTING:

- \*30-Par56 w/300 watt MFL-paired on 15 Dimmer channels-16 Channel Lighting Board
- \*Disco Ball!-on Dimmer channel 1

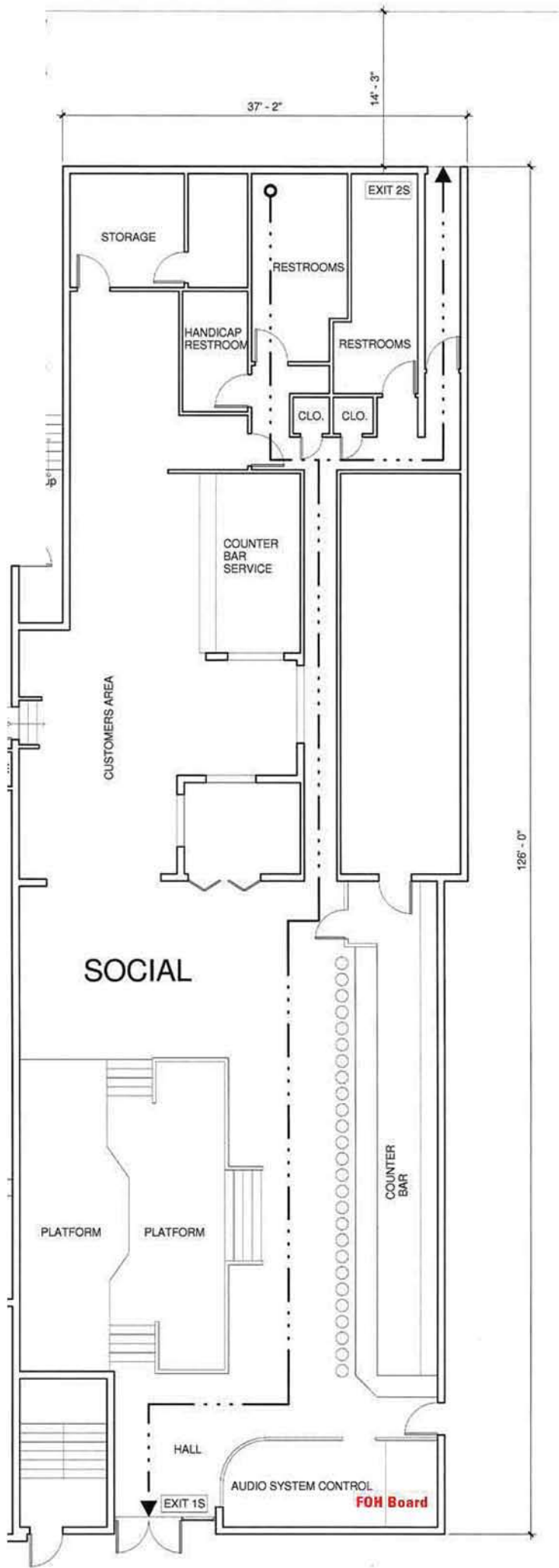

**thesocial**

54 N Orange Ave. Downtown, Orlando  
 407.246.1419 THESOCIAL.ORG



**thesocial**

54 N Orange Ave. Downtown, Orlando  
407.246.1419 THESOCIAL.ORG